

# Installation Instructions

ANTI-VIBRATION PRODUCTS | EXPANSION COMPENSATORS | FLEXIBLE CONNECTORS | ACOUSTIC PRODUCTS | THERMAL INSULATION

## ANTI-VIBRATION PRODUCTS

### MMS1-E Extended Range Enclosed Spring Mount

Before installation please carefully review the data below to ensure your equipment and installation environment does not exceed the products limitations.

Operating Temperature Range: -20°C to +80°C

**NOTE - Failure to install the correct mount may result in the potential failure of the anti-vibration mount.**

**NOTE - These mounts should only be used in compression, never in tension or shear.**



Mount Variant	Max Load Kg / (N)	Colour Code	Mount Variant	Max Load Kg / (N)	Colour Code
MMS1-E-200	200 / (1960)	Red	MMS1-E-700	700 / (6860)	Black
MMS1-E-300	300 / (2940)	Claret	MMS1-E-800	800 / (7840)	Yellow
MMS1-E-400	400 / (3920)	Grey	MMS1-E-1000	1000 / (9800)	Blue
MMS1-E-500	500 / (4900)	Orange	MMS1-E-1400	1400 / (13720)	White
MMS1-E-600	600 / (5880)	Brown			

#### STEP 1

Ensure all the anti-vibration mounts are of the correct variant for the application and are undamaged.

Place on a level surface and remove the levelling screw, nut and washer from each anti-vibration mount before positioning in the desired locations beneath the equipment to be isolated.



#### STEP 4

By screwing the levelling screw into the mount, the outer cup will rise thus allowing the equipment to be levelled.

The levelling process should take place by first starting with the mount that has deflected the greatest and continuing in ascending order until the equipment is level.

#### STEP 2

Line up the holes in the base of the equipment with the threaded holes in the anti-vibration mounts.

Proceed to lower the equipment down onto the anti-vibration mounts.

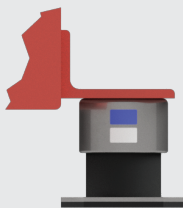

#### STEP 5

Once the equipment has been levelled, tighten up the lock nut on each anti-vibration mount so as to suitably secure the equipment at each location.

Each mount features two slots to allow for it to be bolted directly to the floor or supporting structure.

#### STEP 3

It will be noted that each mount will have deflected by a varying amount due to the static loads applied.

With the lock nut wound up to the head of the levelling screw, insert it into the mounts threaded hole.

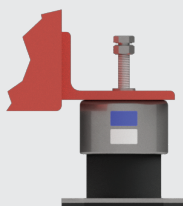

#### STEP 6

Further adjustment and maintenance should not be required.

However we do recommend that visual inspections take place to check for accidental damage or misuse.

